



2/21 Everist Road Ocean Grove VIC

The Feel:

Strategically positioned within Ocean Grove's best industrial precinct, these brand-new factory/warehouses are set to push the standard of commercial operations to exciting new heights. The ultra-modern architect-designed hub offers a compilation of five purpose-built business bases, with insightful design and optimal use of space at the forefront. Ranging in size from 116sqm - 196sqm (approx.), each factory is equipped with the very best of amenities including dedicated mezzanine level, 5m roller door access, kitchenette, and accessible toilets, while premium finishes and landscaped gardens set a sophisticated tone for your day-to-day business operations.

The Facts:

- High-end industrial warehouse/factory development designed by JAM Architects
- Groundbreaking for Ocean Grove with modern design thoughtfully balancing size, space & style
- Available to purchase off the plan for the astute occupier or investor

[For full version visit the website](https://www.bellarineproperty.com.au/8135080)

Type	: Industrial
Price	: \$ 749,000
Building Size	: 116 sqm
View	: https://www.bellarineproperty.com.au/8135080



Christian Bartley
03 5254 3100



Andrew Kibbis
03 5254 3100

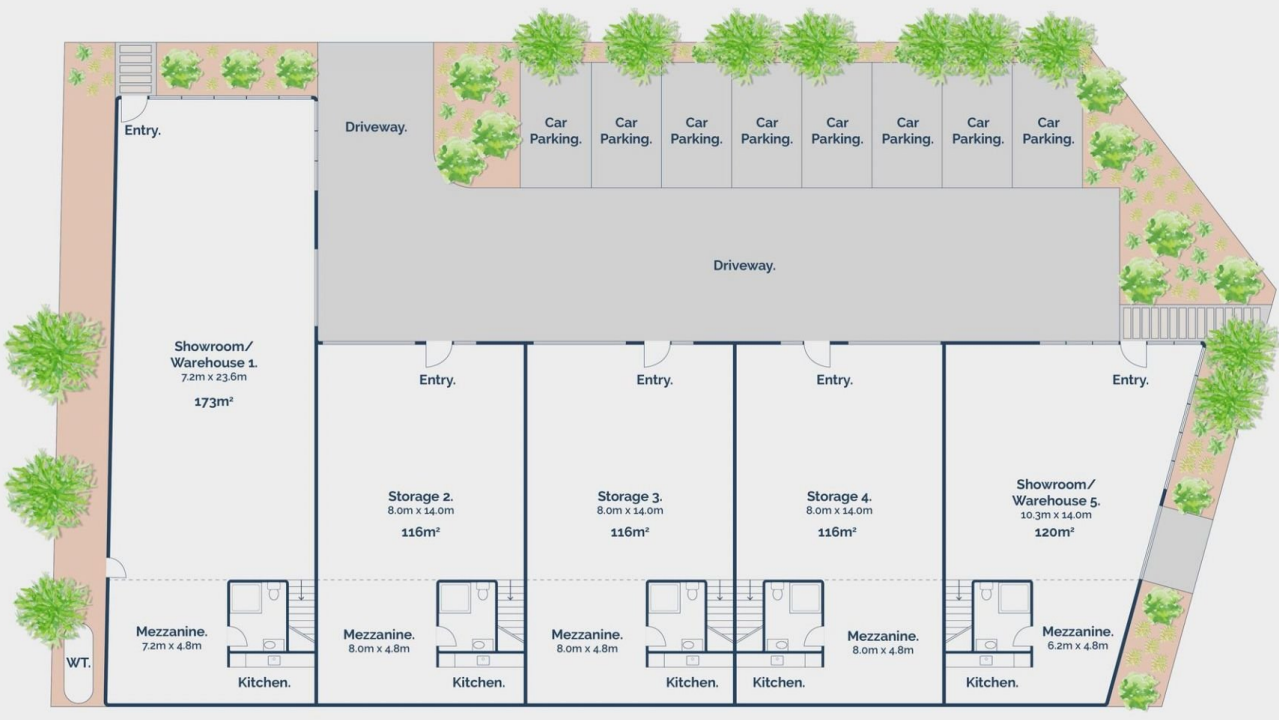

21 Everist Road, Ocean Grove



Whilst bwr.com.au has made every attempt to ensure the accuracy of the floor plan contained here, measurements are approximate and no responsibility is taken for any error, omission, or mis-statement. This plan is for illustrative purposes only.