



## 21 Cottesloe Drive Barwon Heads VIC

2 1

### The Feel:

Seize this opportunity to secure a generous 613m<sup>2</sup> (approx) block in the highly sought-after Cottesloe Drive, Barwon Heads. Surrounded by quality homes and a vibrant community of young families, this premium location offers the perfect canvas to envision and build your dream coastal home (STCA). While the existing two-bedroom home provides a basic footprint, the real value lies in the potential to create something truly special in this peaceful, family-friendly neighbourhood. Set amongst Barwon Heads' famed Moonah Trees, the sheltered setting is moments away from the Village Park, river, primary school, and Barwon heads golf course.

### The Facts:

- Highly sought-after location on Cottesloe Drive, surrounded by quality homes & a welcoming community
- Generous 613sqm (approx) block offering exceptional potential for redevelopment (STCA)
- North frontage & western boundary provide opportunities for passive solar benefits

[For full version visit the website](https://www.bellarineproperty.com.au/81243)

**Type** : House  
**Price** : \$1,090,000-\$1,190,000  
**Land Size** : 613 sqm  
**View** : <https://www.bellarineproperty.com.au/81243>  
28



**Levi Turner**  
03 5254 3100



**Peta Walter**  
03 5254 3100

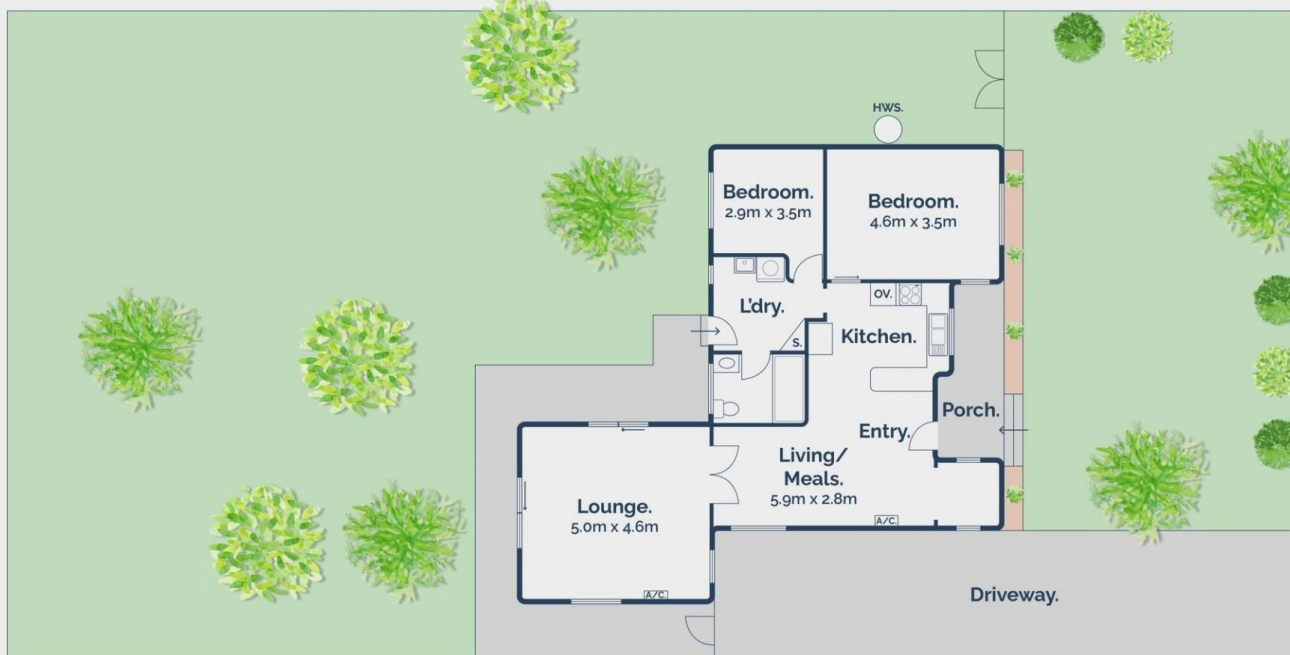

## 21 Cottesloe Drive, Barwon Heads



Whilst [bwrn.com.au](http://bwrn.com.au) has made every attempt to ensure the accuracy of the floor plan contained here, measurements are approximate and no responsibility is taken for any error, omission, or mis-statement. This plan is for illustrative purposes only.