

4/34 Murradoc Road Drysdale VIC



This spacious and well positioned factory is situated in the heart of Drysdale's established commercial precinct. This outstanding property offers a great entry into the leasing market at an affordable price.

The Facts:

- Premier inner-Drysdale location
- Established commercial precinct, underpinned by nearby large corporates including Coles, Aldi & KFC
- Commercial 2 Zoning
- 117sqm of factory floor space with 7m ceilings
- 70sqm mezzanine for extra storage
- Easy access off the street
- 5m remote roller door

*All information offered by Bellarine Property is provided in good faith. It is derived from sources believed to be accurate and current as at the date of publication and as such Bellarine Property simply pass this information on. Use of such material is at your sole risk. Prospective purchasers are advised to make their own inquiries with respect to the information that is passed on. Bellarine Property will not be liable for any loss resulting from any

Price : Under Application
Building Size : 117 sqm
View : <https://www.bellarineproperty.com.au/8109373>



Levi Turner
03 5254 3100



Christian Bartley
03 5254 3100

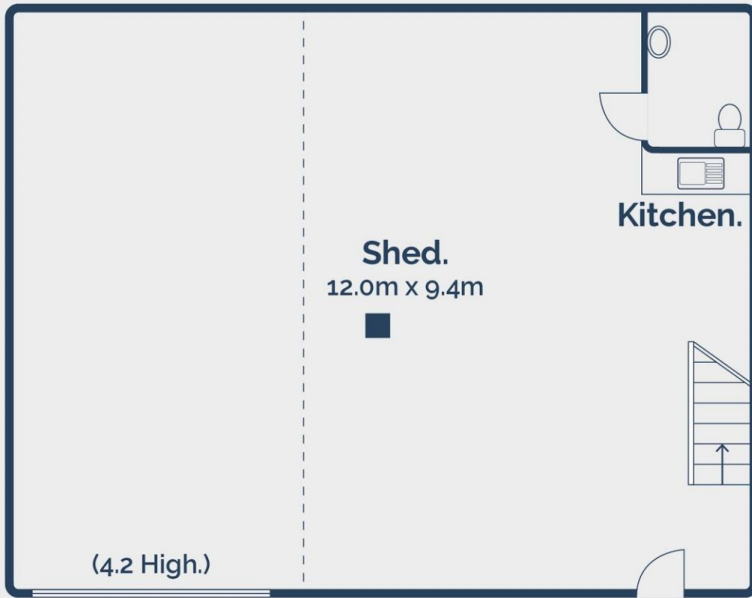

Ground Floor.

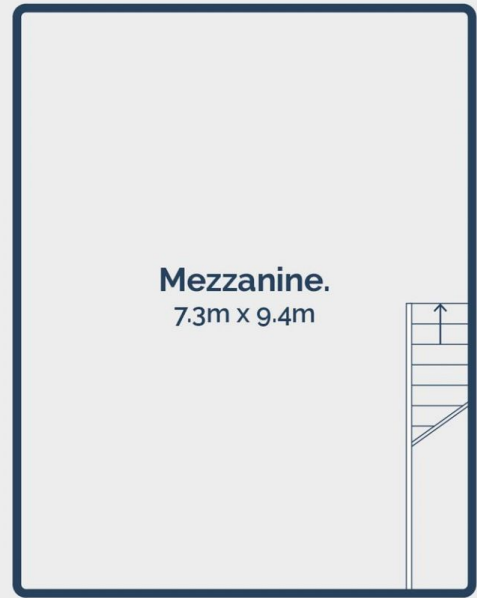

First Floor.

4/34 Murradoc Road, Drysdale



Whilst bwrn.com.au has made every attempt to ensure the accuracy of the floor plan contained here, measurements are approximate and no responsibility is taken for any error, omission, or mis-statement. This plan is for illustrative purposes only.