



28 Point Richards Road Portarlington VIC

4 🚗 4 🚗 3 🚗

The Feel:

Breathtaking in its beauty and uncompromising in its quality, this custom residence is set to spoil with its impressive family proportions positioned against a spectacular panorama across Corio Bay. Lavishly appointed over 2 levels connected by an internal lift, the home's family focused layout features 4 distinct living areas alongside 4 ensuite bedrooms, as blackbutt flooring, feature Wathaurong glass, vast banks of windows, and a stone kitchen that's tailor-made for entertaining complement the overall ambience of seaside luxury. Complete with dual access parking, 5kW of solar, and a home office that's ideal as a 5th bedroom, discover first-class living in an exclusive bayside address.

The Facts:

- Custom family home holding a commanding position with spectacular rural, bay & You Yangs views
- Discover luxe living, spectacularly set against a backdrop of blue water hues & majestic painterly sunsets
- The family-focused home is presented over 2 expansive

[For full version visit the website](https://www.bellarineproperty.com.au)

Type : House
Price : \$1,275,000-\$1,375,000
Land Size : 751 sqm
View : <https://www.bellarineproperty.com.au/8107041>



Lee Martin
03 5297 3888



Andrew Kibbis
03 5254 3100

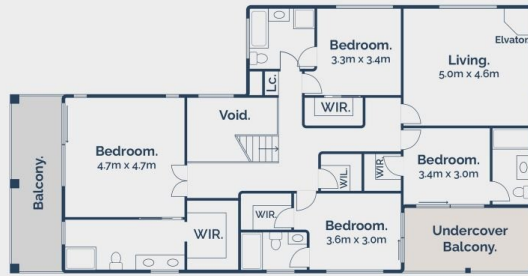

First Floor.

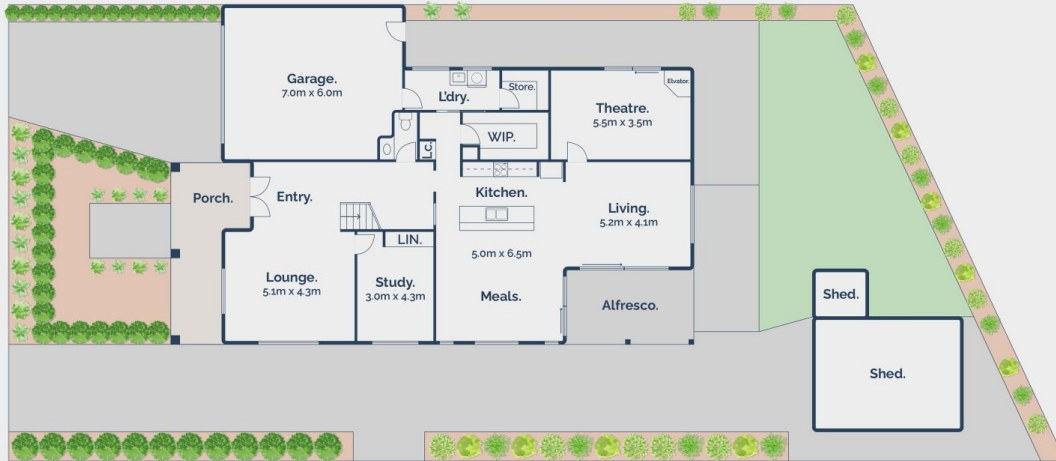

Ground Floor.



28 Point Richards Road, Portarlington



Whilst bwr.com.au has made every attempt to ensure the accuracy of the floor plan contained here, measurements are approximate and no responsibility is taken for any error, omission, or mis-statement. This plan is for illustrative purposes only.