



2/80 Murradoc Road Drysdale VIC



The Feel:

Positioned with street frontage to Murradoc Road, in the heart of the Drysdale town centre and benefitting from strong passing traffic, this commercial building occupies a quality position. With favourable Commercial 2 Zoning, the property is currently tenanted to an established business, and presents a wonderful opportunity to secure a near new building in a superb industrial locale, with strong rental returns.

The Facts:

- Outstanding commercial opportunity in Drysdale's industrial hub
- Near new property of 140sqm with four car spaces
- Secure tenancy until 2027 with options
- Kitchenette and disabled bathroom facilities
- 5m rear roller door provides outstanding entry clearance & access
- On-site car parking for up to four vehicles
- Unrivalled lifestyle amenity with Drysdale's retail and hospitality precinct within immediate proximity
- Located amongst key local businesses including Coles, Aldi, Repco, Drysdale Removals & KFC

Price : \$900,000
Building Size : 140 sqm
View : <https://www.bellarineproperty.com.au/8097633>



Levi Turner
03 5254 3100



Lee Martin
03 5297 3888

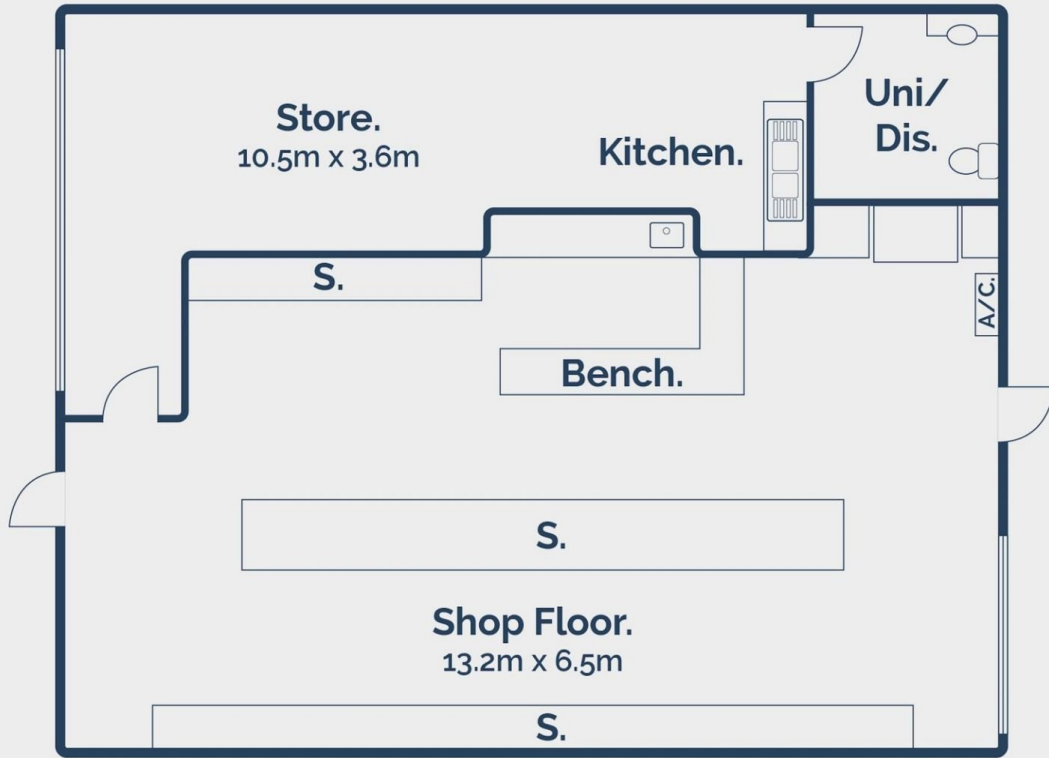

2/80 Murradoc Road, Drysdale



Whilst bwrn.com.au has made every attempt to ensure the accuracy of the floor plan contained here, measurements are approximate and no responsibility is taken for any error, omission, or mis-statement. This plan is for illustrative purposes only.