



**44 Flagstaff Drive Portarlington VIC**

3 2 2

**The Feel:**

Instantly appealing with its peaceful tree-lined setting and modern elegance, this immaculate 3-bedroom residence provides the most idyllic seaside hideaway for growing families, empty nesters, and lifestyle lovers. Classic neutral tones and warm timber-look flooring work in tandem with bright and sunny interiors extending to impressive outdoor entertaining and beautifully manicured gardens to create a modern sanctuary vibe, as its whisper-quiet lifestyle setting is 3-minutes from the foreshore and vibrant heart of Portarlington Village.

**The Facts:**

- Discover elegance & modern comfort in this well-appointed single-level residence
- The perfect start for a young family or an outstanding opportunity for active retirees
- Less than 5-years old, it is set within the peaceful surrounds of Arlington Rise Estate
- The home exudes a welcoming ambience with its manicured gardens & generous interior proportions
- The undisputed heart of the home is the expansive open-plan living hub flowing seamlessly to the undercover

**Price** : \$860,000-\$910,000  
**Land Size** : 544 sqm  
**View** : <https://www.bellarineproperty.com.au/8046069>



**Lee Martin**  
03 5297 3888



**Andrew Kibbis**  
03 5254 3100

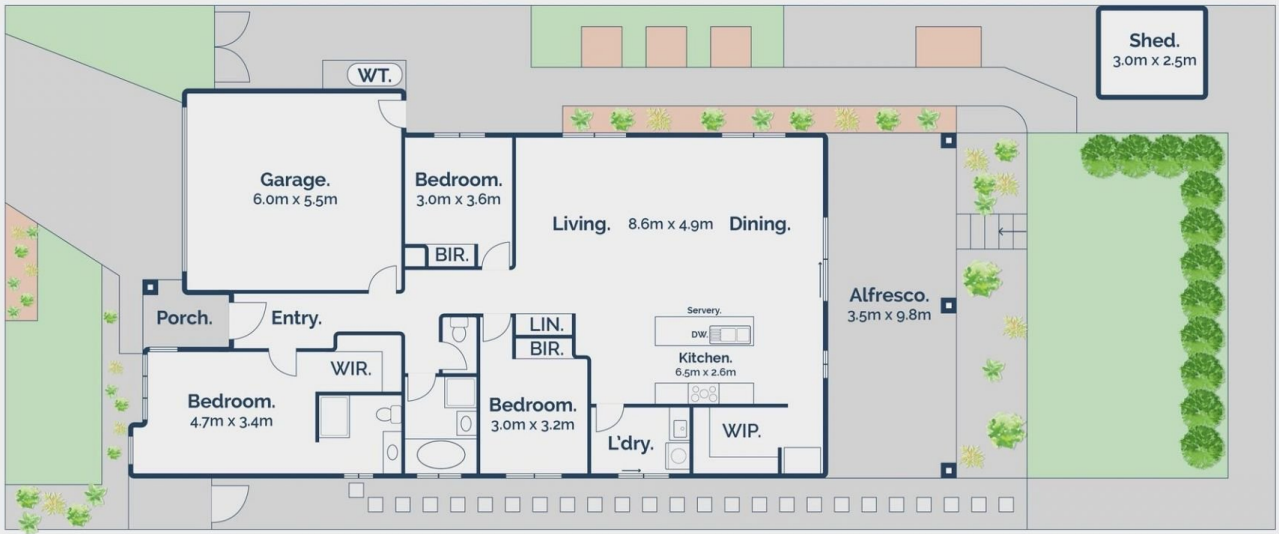

3 2 2

## 44 Flagstaff Drive, Portarlington



Whilst [bwr.com.au](http://bwr.com.au) has made every attempt to ensure the accuracy of the floor plan contained here, measurements are approximate and no responsibility is taken for any error, omission, or mis-statement. This plan is for illustrative purposes only.