



**17A Wattlebird Crescent Barwon Heads VIC**

5 🛏 3 🚿 1 🚗

**The Feel:**

Situated in one of the best streets in Barwon Heads, 17a Wattle Bird Crescent offers a serene retreat that combines the charm of natural surroundings with the comfort of a quality build by an esteemed local builder. The five bedroom, multi living, home draws you in with an enclosed mudroom that transitions into a breathtaking open space, flaunting double-height cedar-lined ceilings and a striking Blackwood staircase. Exposed brick and a unique porthole window accentuate the space with a dash of character and warmth. The property marries architectural finesse with a homely ambience, ideally situated close to the river for leisurely strolls and fishing.

**The Facts:**

- Constructed by esteemed local builder Peter Roos with high attention to detail
- Unique architectural features including double-height cedar-lined ceilings & a Blackwood hardwood staircase
- Enclosed mudroom transitions into a spacious main living zone
- Exposed brick & character-enhancing porthole window to the formal sitting room & dining area

**Price** : \$ 1,100,000  
**Land Size** : 592 sqm  
**View** : <https://www.bellarineproperty.com.au/8040720>



**Peta Walter**  
03 5254 3100



**Mark Day**  
0437353902



Ground Floor.

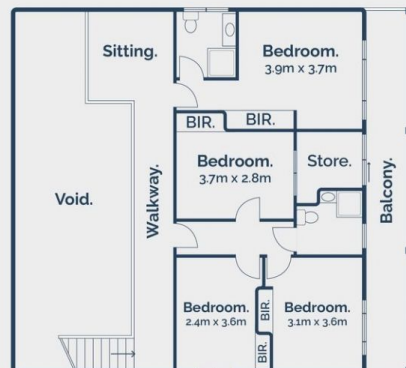

First Floor.

5 3 2

# 17A Wattle Bird Crescent, Barwon Heads



Whilst [bwr.com.au](http://bwr.com.au) has made every attempt to ensure the accuracy of the floor plan contained here, measurements are approximate and no responsibility is taken for any error, omission, or mis-statement. This plan is for illustrative purposes only.