



## 2/89 The Avenue Ocean Grove VIC

4 2 2

### The Feel:

Park Avenue is a collection of architecturally designed and artfully considered homes in the heart of old Ocean Grove. Unique and captivating, this park-side residence is in a remarkable location, with north-facing aspect. This double-storey home with soaring ceilings has a home office and study nook, two living areas and offers the flexibility of a 4th bedroom. The result is a rare combination of exquisite park and seaside living, tied together by elegance, quality and a soulful connection to this vibrant coastal township. Set amongst the tall trees of the Draper Street park on this extraordinary corner position, Park Avenue takes classic architectural forms and reinterprets them with an inspired contemporary vision - welcome home.

### The Facts:

- Parkside living with open spaces, walking tracks, exercise circuit training tracks & playground - a park for the community to enjoy
- Local coastal village, cafes & restaurants at your door - forget the car!
- Strong silhouette demonstrates a uniquely contextual & respectful coastal design

**Price** : \$ 1,585,000

**Land Size** : 170 sqm

**View** : <https://www.bellarineproperty.com.au/66262>  
38



**Dan Halsey**  
03 5254 3100

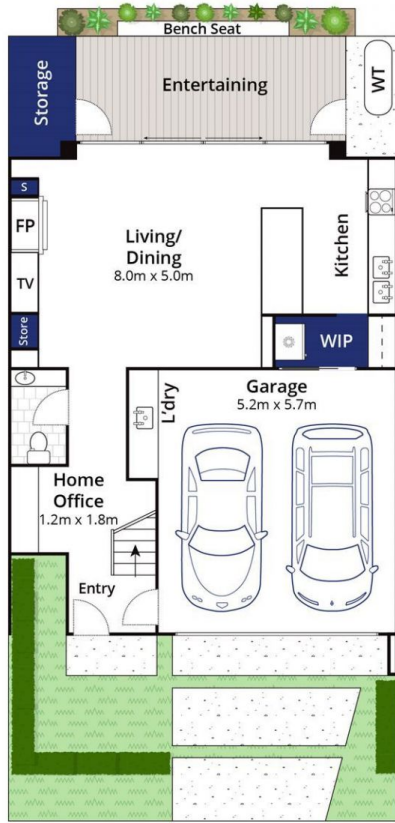

Ground Floor

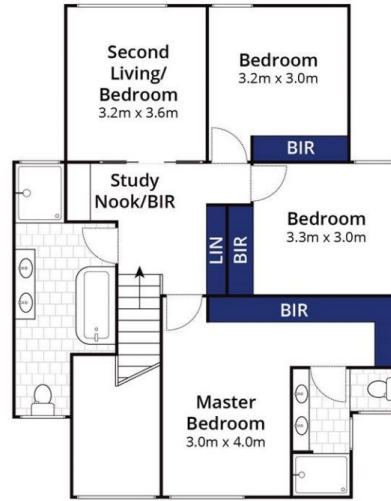

First Floor

Whilst [bwrn.com.au](http://bwrn.com.au) has made every attempt to ensure the accuracy of the floor plan contained here, measurements are approximate and no responsibility is taken for any error, omission, or mis-statement. This plan is for illustrative purposes only.

## Residence 2/89 The Avenue, Ocean Grove

**bellarine** property  
Rentals | Commercial | Sales | Projects

