



**119 Sheepwash Road Barwon Heads VIC**

3 🏠 2 🚗 2 🚗

Just metres from the banks of the Barwon and adjoining a reserve, this ideally placed Dennehy home is peaceful and private and brimming with quality features.

- Perfect floorplan is full of natural light with feature glazing framing private garden views
- Have the flexibility of a master upstairs or downstairs
- The master suite shares the ground level allowing downsizers to live comfortably on the ground level
- Two bedrooms share a central bathroom and walk-in robe, both with semi en suite access
- The main bedroom, with split system AC, flows to a sunny treetop balcony with views of the river
- This level is ideal for visiting family or teens
- The main lounge, with soaring ceilings and direct alfresco access is abundant with natural light and north facing
- Entertaining will be a breeze with the main living, lounge and two alfresco areas butting off the kitchen
- Elegant etched glass doors zone the living spaces from the bedrooms allowing privacy
- Smeg 900mm gas/electric cooker, Bosch dishwasher and Eco stone benchtops, complete the central kitchen
- The stunning parquetry floors are a highlight

**Land Size** : 585 sqm  
**View** : <https://www.bellarineproperty.com.au/4090363>



**Levi Turner**  
03 5254 3100



**Peta Walter**  
03 5254 3100

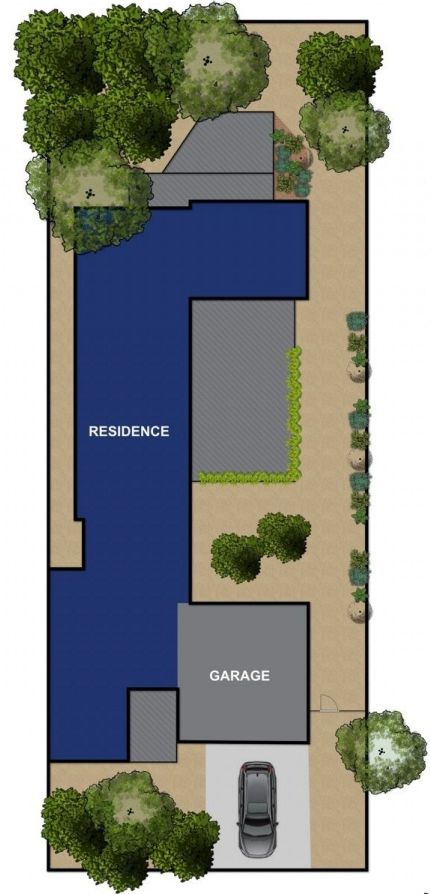
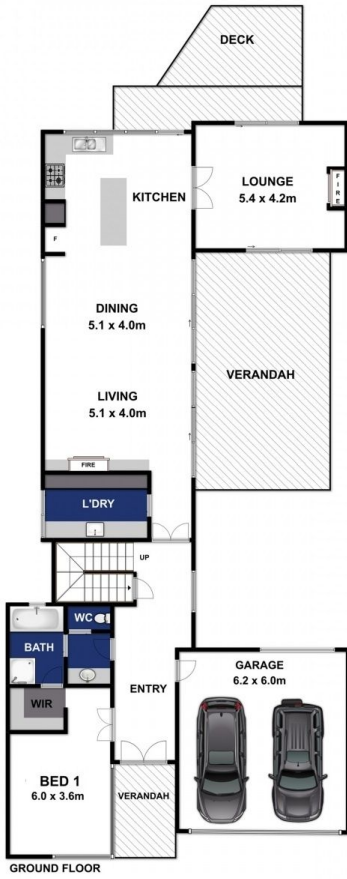

Approx Area 277.5m<sup>2</sup>

Whilst [bwrn.com.au](http://bwrn.com.au) has made every attempt to ensure the accuracy of the floor plan contained here, measurements are approximate and no responsibility is taken for any error, omission, or mis-statement. This plan is for illustrative purposes only.

**119 Sheepwash Rd, Barwon Heads**

bellarineproperty