



9 Arlia Mews Ocean Grove VIC

4 2 2

With quality, style and proportions to rival an elite penthouse, this home provides a variety of spaces for every member of the family. Centrally located in The Parks Estate near wetlands, The Market Place shops and schools, this 4-bedroom, 3-living area home flows elegantly over two levels with lush gardens and inviting alfresco spaces for year round enjoyment.

Price : \$ 667,000
Land Size : 576 sqm
View : <https://www.bellarineproperty.com.au/28416>
 74

- Sandstone and cladding home of generous proportions finished with high quality features
- Living zones downstairs with the open plan kitchen/living/dining area at the rear
- Picturesque dining zone with a bay of windows raining in natural light and garden views
- French doors lead from the living area to a sheltered patio and impressive alfresco pavilion
- Alfresco pavilion on Merbau decking with built-in seating and outdoor speakers
- Superb white kitchen fitted with stainless steel appliances, Caesarstone and 2-pac cabinetry
- Appliances include; Westinghouse dishwasher, wall oven and grill and gas cooktop
- Custom fitted office positioned at the facade, ideal for a



Dan Halsey
 03 5254 3100



Toby Lee
 03 5254 3100

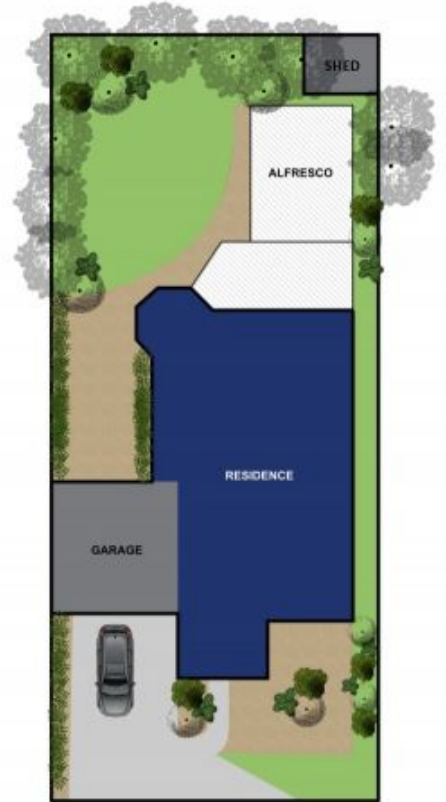

241.13m² (residence - approx)

9 ARLIA MEWS, OCEAN GROVE

Whilst every attempt has been made to ensure the accuracy of the floor plan contained here, measurements of doors, windows, rooms and any other items are approximate and no responsibility is taken for any error, omission, or mis-statement. This plan is for illustrative purposes only and should be used as such by any prospective purchaser. The services, systems and appliances shown have not been tested and no guarantee as to their operability or efficiency can be given.