



5/22-24 Grove Road Barwon Heads VIC

3 🏠 2 🚗 2 🚗

High-end architectural design and an inner-village location come together with outstanding effect in this premium coastal property. This special villa, nestled by grand flowering gums, offers total privacy, expansive light-filled living over two levels and three extraordinarily large bedrooms. Get set for classy coastal escapes or a rewarding downsize!

Price : \$ 1,325,000
Land Size : 331 sqm
View : <https://www.bellarineproperty.com.au/2333602>

- Ideally located behind Hitchcock Ave with a private walking track to the shops
- Boasting timeless architectural design perfectly matched to the environment
- Wide glazing brings the 'calm' of the treed landscape in, and floods the floor plan with light
- Expansive open plan living on the lower level with access to north and south facing courtyards
- Feature hardwood floors, industrial-sized sliding windows, lofty ceilings and stylish neutrality
- Bright and spacious kitchen with vision over indoor and outdoor living zones
- Impressive suite of Bosch appliances, glass splashback and large Caesarstone island bench
- Electric oven, instant heat cooktop, slimline range hood



Christian Bartley
03 5254 3100



Levi Turner
03 5254 3100

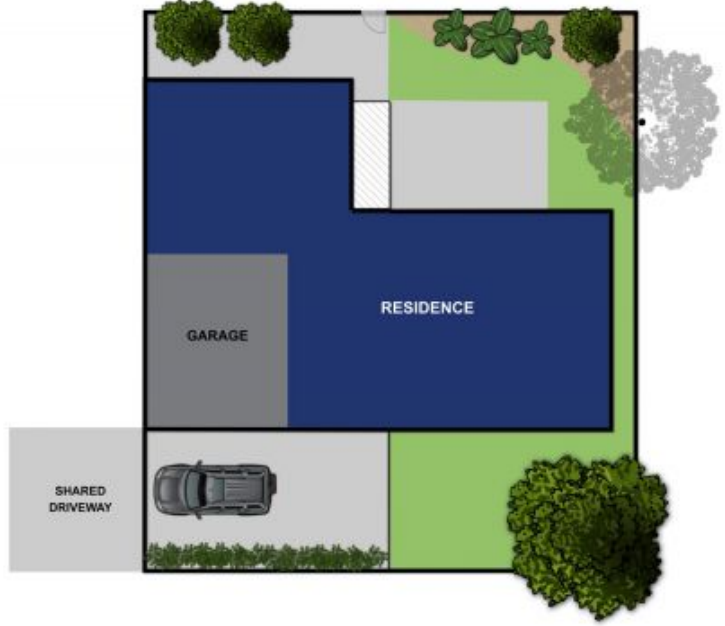

5/22 GROVE ROAD, BARWON HEADS

Whilst every attempt has been made to ensure the accuracy of the floor plan contained here, measurements of doors, windows, rooms and any other items are approximate and no responsibility is taken for any error, omission, or mis-statement. This plan is for illustrative purposes only and should be used as such by any prospective purchaser. The services, systems and appliances shown have not been tested and no guarantee as to their operability or efficiency can be given.