



27-29 Thomson Drive Barwon Heads VIC

3 2 1

Where can you find a double block of some 700m² each, offering two separate titles? What about a double block in the Barwon Heads?? golf precinct, with possible golf course views, along with a number of development and investment opportunities? With easy access to Geelong Road and Golf Links Road, walking distance to Barwon Heads?? Golf Club, shops, cafes, beach and river; the convenience of this opportunity is too good to refuse. Live in a beautiful treed locale while being positioned away from the holiday hustle and bustle! Secure this precious parcel and the options and rewards are endless!

- The sunken block provides the ultimate privacy and cosiness
- Well retained gardens to the front create a level ground for the home & rear garden
- 3 bedroom, 2 bathroom brick veneer home offers solid and timeless features
- The outlook from the home consists of vast lawns leading to well established shrubbery
- The lounge features a wood heater built in to a brick fireplace for cosy winters
- A long stretching verandah creates an alfresco space to

Land Size : 1464 sqm
View : <https://www.bellarineproperty.com.au/1639906>



Christian Bartley
03 5254 3100

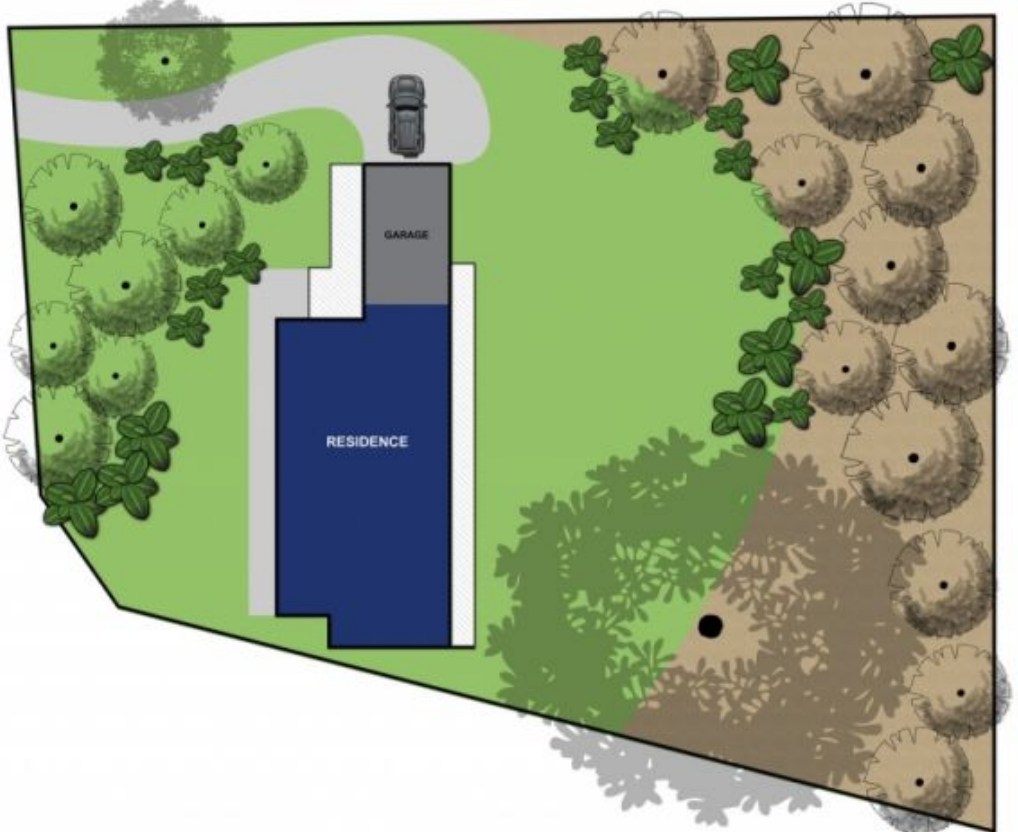

27-29 THOMSON DRIVE, BARWON HEADS

Whilst every attempt has been made to ensure the accuracy of the floor plan contained here, measurements of doors, windows, rooms and any other items are approximate and no responsibility is taken for any error, omission, or mis-statement. This plan is for illustrative purposes only and should be used as such by any prospective purchaser. The services, systems and appliances shown have not been tested and no guarantee as to their operability or efficiency can be given.